

# General Dimensions of Standard Malleable Iron Screwed Fittings Banded

150lb Steam Working Pressure

300lb Cold Water, Oil or Gas, Non-Shock Working Pressure

## 90° ELBOW

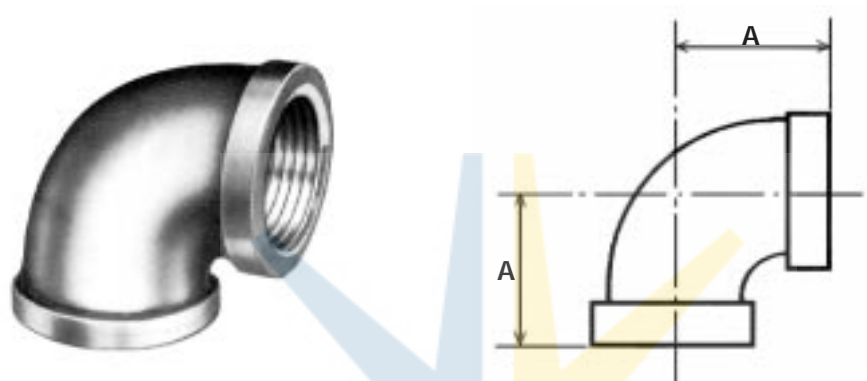

I.P. Inches	DIMENSIONS (INCHES)	
	A	
1/8	11/16	
1/4	13/16	
3/8	15/16	
1/2	1 1/8	
3/4	1 5/16	
1	1 1/2	
1 1/4	1 3/4	
1 1/2	1 15/16	
2	2 1/4	
2 1/2	2 11/16	
3	3 1/8	
3 1/2	3 7/16	
4	3 3/4	
5	4 1/2	
6	5 1/8	

**BACK TO**

**CATALOGUE**